

**■ D1 Multi-Purpose Square Toolholder Form D1**

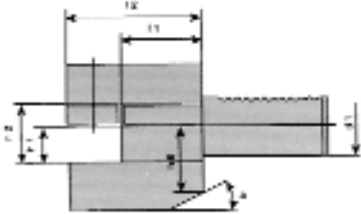

Ordering No.	D1	B1	B2	B3	B4	H1	H2	H3	H4	H6	L1	L2	a
VDI-30-D1	30	35	17	41	23	20	29	28	38	30	42	60	25°
VDI-40-D1	40	42.5	21	47.5	25.5	25	34	32.5	48	-	50	72	-
VDI-50-D1	50	50	26	55	30.5	32	41	35	60	-	60	85	-
VDI-60-D1	60	57.5	33	57.5	33	32	41	42.5	62.5	-	85	110	-

DIN.69880 Part 5

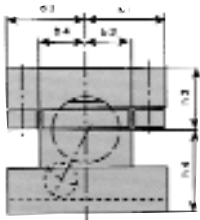

**■ D2 Multi-Purpose Square Toolholder Form D2 Overhead**

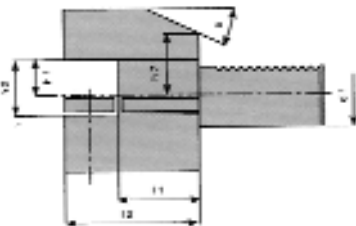

Ordering No.	D1	B1	B2	B3	B4	H1	H2	H4	H5	H6	L1	L2	a
VDI-30-D2	30	35	17	41	23	20	29	38	35	28	42	60	25°
VDI-40-D2	40	42.5	21	47.5	25.5	25	34	48	42.5	-	50	72	-
VDI-50-D2	50	50	26	55	30.5	32	41	60	50	-	60	85	-
VDI-60-D2	60	57.5	33	57.5	33	32	41	62.5	62.5	-	85	110	-

DIN.69880 Part 5